

CABLE(RG142B/U, RG223/U, RG400/U)

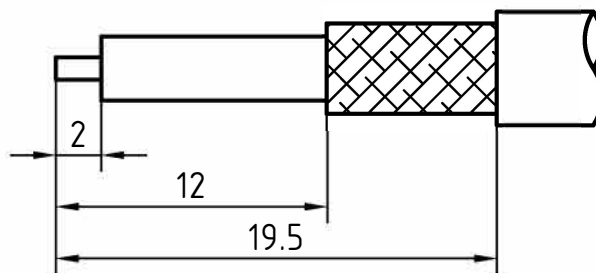

5	1	Gasket	Silicon rubber	
4	1	Coupling nut	Brass/Nickel plated	
3	1	Body	Brass/Nickel plated	
2	1	Insulator	PTFE	
1	1	Center contact	Brass/Gold plated	
Itemref	Quantity	Title/Name, designation, material, dimension etc		Article No./Reference

Designed by
Xio Xang

Checked by
Jing Lo

Approved by
Jing Chan

File name
N-111200B

Date
06.07.17

Scale
4 : 1

RF CONNEC

N-111200B

Edition
1.0

Sheet
1/1

DESCRIPTION:

N Type male R/A connector

Electrical data:

<i>Impedance:</i>	50 ohm
<i>Frequency range:</i>	DC to 11 GHz
<i>Return loss(LMR195):</i>	$\leq 1.10 + 0.06 \times f \text{ (GHz)}$
<i>Insertion loss(LMR195):</i>	$\leq 0.15 \times \sqrt{f[\text{GHz}]} \text{ dB}$
<i>Insulation resistance:</i>	$\geq 5000\text{M}\Omega$
<i>Test voltage:</i>	2500 V rms
<i>Working voltage:</i>	1400 V rms
<i>Contact resistance:</i>	
1). <i>Centre contact:</i>	1.0 m Ω
2). <i>Outer conductor:</i>	0.25 m Ω
<i>Power handling</i> (at 20 °C, sea level, VSWR 1.0):	1000 W @ 1 GHz 700 W @ 2 GHz
<i>RF-leakage:</i>	$\geq 128 \text{ dB up to } 1 \text{ GHz}$
<i>- Limitations are possible due to the used cable type -</i>	

Environmental data:

<i>Temperature rating:</i>	-65 ° C to +165 ° C
<i>52/95/EC (RoHS):</i>	Compliant

Mechanical data:

<i>Mating cycles:</i>	≥ 500
<i>Coupling nut retention:</i>	$\geq 450 \text{ N}$
<i>Coupling test torque:</i>	$\leq 1.7 \text{ Nm}$
<i>Recommended torque:</i>	0.7 Nm to 1.1 Nm

Suitable cables:

RG142B/U, RG223/U, RG400/U